



The **TARGHEE** home plan by Simplicity



The 2042 square foot Targhee is an efficiently planned two-story home popular with those in need of generous comfort. The home's alley-accessed garage creates amazing street appeal. The first floor is home to an expansive living room, large dining room and adjoining kitchen featuring a useful island. The large, private main suite boasts a generous dual vanity bath with a spacious closet, while the other two sizeable bedrooms – one of which can be converted into an optional den – share the second bathroom. Upstairs, an enormous bonus room can be used for a host of purposes, including an optional 4th bedroom and additional bath.



SIMPLICITY
BY HAYDEN HOMES

The **TARGHEE** home plan by Simplicity



3 BEDROOMS **2** BATHROOMS **2042** SQUARE FEET

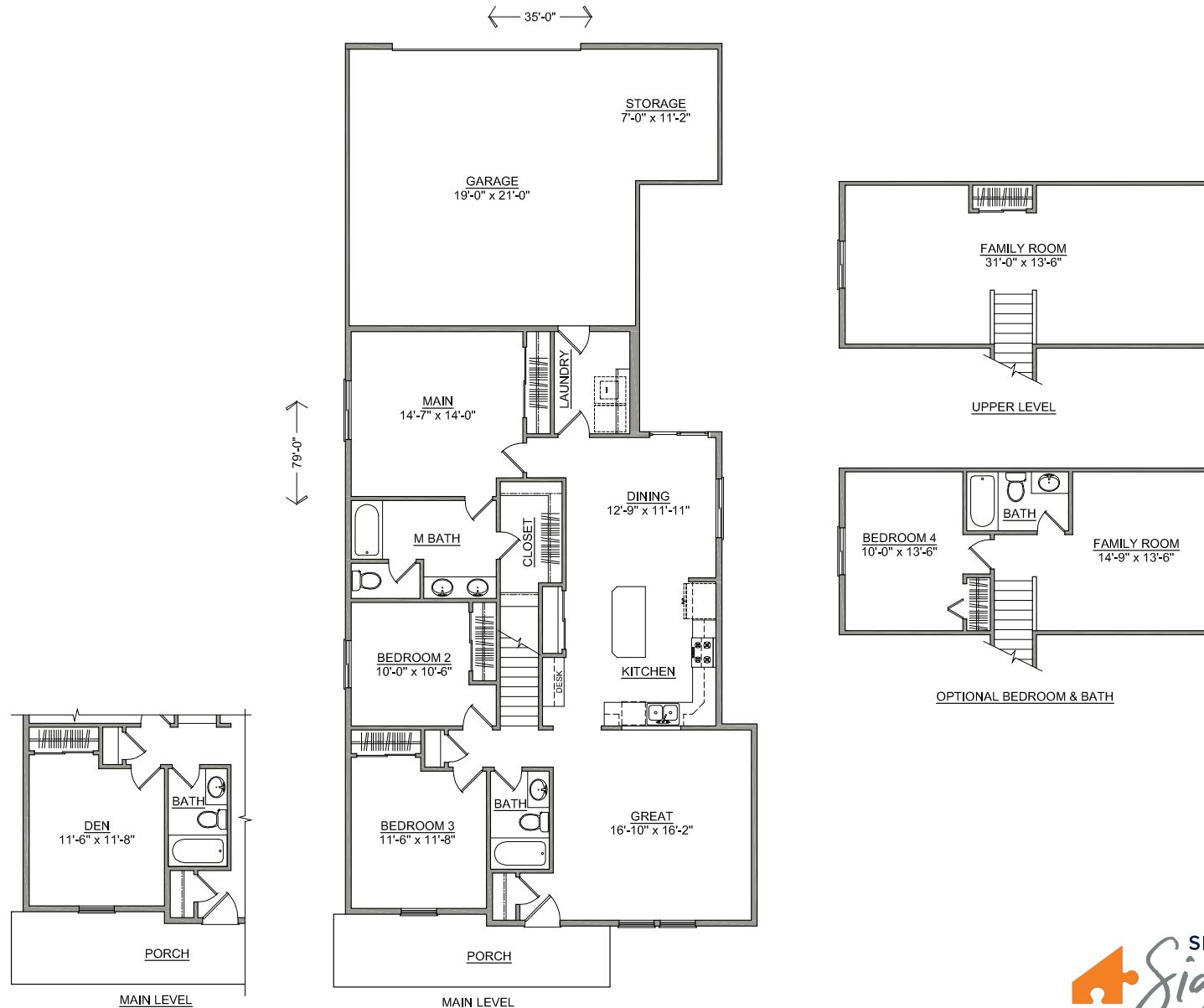

SIMPLICITY
Signature
SERIES

Build your new home online at www.SIMPLICITY-HOMES.com

Prices, home designs and inclusive features are subject to change at any time without notice. Home plan dimensions and square footage are approximate. Area-specific inclusive features are subject to jurisdictional requirements. OR-185357 WA-SIMPLH915C8 ID-RCE34089