



The **ORCHARD** home plan by Simplicity



At 1800 square feet, the Orchard is an efficiently designed, mid-sized single-level home offering both space and comfort. The open kitchen is a chef's dream, with counter space galore, plenty of cupboard storage and a breakfast bar. The expansive living room and adjoining dining area complete this eating and entertainment space, with the added appeal of an optional desk or beverage center. The spacious and private main suite boasts a dual vanity bathroom, separate shower and an enormous closet. The other two sizable bedrooms - one of which can be converted into a den or office - share a second bathroom. An additional feature of this already spacious home is the optional fourth bedroom, which may be converted into a den or office as well.



SIMPLICITY
BY HAYDEN HOMES

The ORCHARD home plan by Simplicity



3 BEDROOMS 2 BATHROOMS 1800 SQUARE FEET

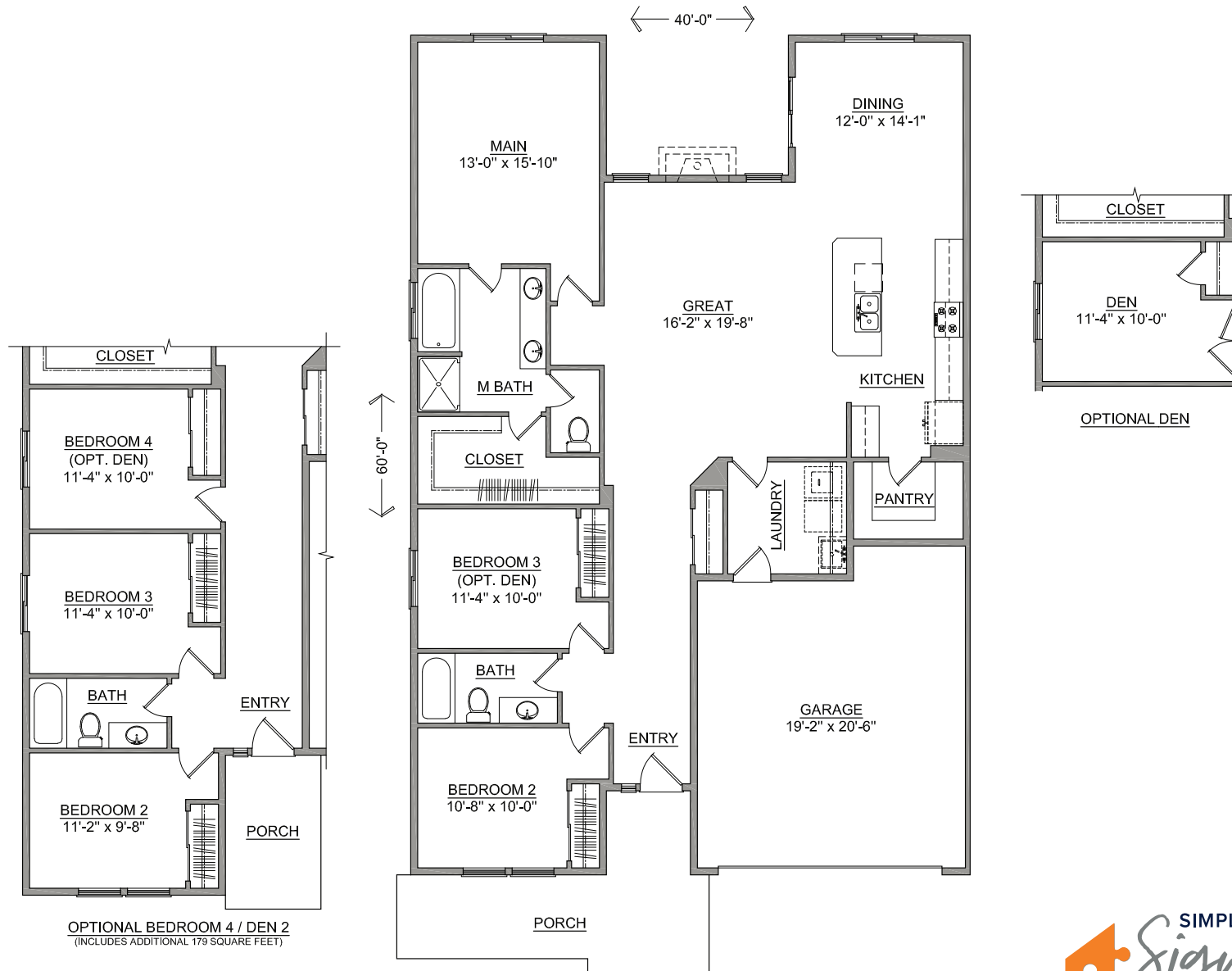

Build your new home online at www.SIMPLICITY-HOMES.com